

Rig Plates

TriRig RP1
PentaPlate RP2
Se7en RP3

CE 0120
EN 795/B

Manufactured in **USA** using domestic & foreign materials

WARNING!



For expert use only!

- These activities are inherently dangerous and carry a significant risk of injury or death that cannot be eliminated.

- It is the user's responsibility to obtain specific training and to use it safely. These instructions DO NOT tell you everything you need to know.

- Do not use unless you can and will understand and assume all risks and responsibilities for all damage/injury/death that may result from use of this equipment or the activities undertaken with it.

- Any device is subject to failure-carefully check before and after each use.

- You must always have a backup-never trust a life to a single tool.

- Everyone using this equipment must be given and thoroughly understand the instructions and refer to them before each use.

- You must have a rescue plan and the means to implement it. Inert suspension in a harness can quickly result in death!

- Do not use around electrical hazards, moving machinery or near sharp edges or abrasive surfaces.

- We are not responsible for any direct, indirect or accidental consequences or damage resulting from the use of our products.

rockexotica.com

rock exotica equipment LC
POB 160470
Freeport Center, F-11
Clearfield, UT 84016
USA
801 728-0630

RP1500 5/2010 A

INTRODUCTION

Thank you for purchasing this Rock Exotica product. We make a variety of rigging plates that excel in a wide variety of uses.

Construction: These rig plates are CNC machined from high strength aluminum alloys. All surfaces are machined and all edges are CNC corner-rounded (not just tumbled) for a superior, large, smooth radius.

History: Rock Exotica designed and manufactured the first widely available production rig plate about 1990. Other designs followed, made both for other companies and under our own brand. We make a wide variety of rig plates, from high performance standard plates to specialized exotic designs.

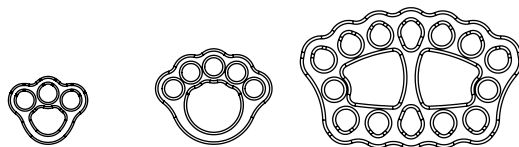

	TriRig	PentaPlate	Se7en
Strength	33kN	33kN	36kN
Height	2.83" (72mm)	3.98" (101mm)	5.97" (152mm)
Width	3.3" (84mm)	4.85" (123mm)	9.36" (238mm)
Weight	1.79 oz. (51gm)	3.84 oz.(108gm)	13.3 oz.(376gm)

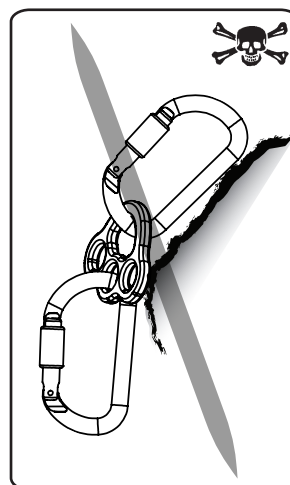
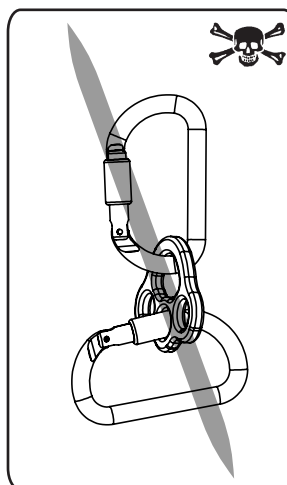
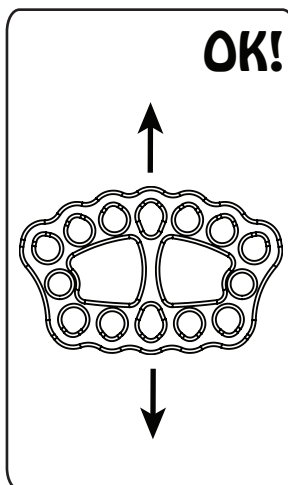

Manufacture Data:
10 001 A
Year, Day of Year, Code

001
Serial No. for the Day

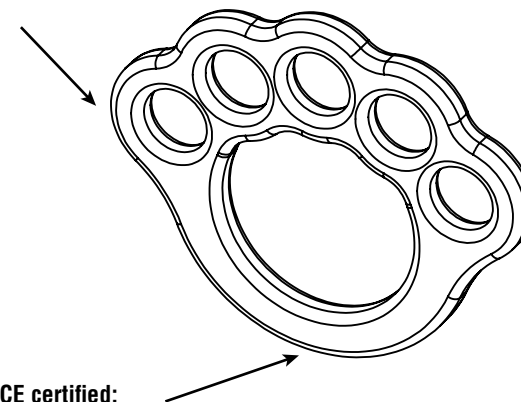

CE certified:

CE 0120 EN 795/B

This product has been tested to EN 795/B, which is for use by a single person. Notified body controlling the manufacturing of this PPE: SGS United Kingdom Ltd. (CE 0120), 202B Worle Parkway, Weston-super-Mare, BS22 6WA UK. Notified body which performed EC type examination: VVUU,a.s., notified body No. 1019, Pikartská 1337/7, Ostrava-Radvanice, Czech Republic.

Intended Use

Only the loading shown as "OK" is allowed. Always verify proper positioning of your system and components.

Equipment must be free to align with the load, any restraint is dangerous.

Make sure you use redundant systems. Personal Protective Equipment (PPE) should only be used with energy absorbing systems such as dynamic ropes, energy absorbers, etc. & slack must be kept out of the system to prevent high impact falls.

This product is intended for use by medically fit, specifically trained and experienced users.

Anchors

Must meet the EN 795 standard. Strength must meet the needs of the particular situation (at least 10kN) and the user must always stay below the anchor.

Clearance under the user must always be enough to prevent hitting anything in case of a fall (the length of this equipment can influence the height of a fall).

Leverage Hazard

A rig plate or other equipment can lever against a connector (such as a carabiner) and break it, opening the connector and causing disconnection. Guard against this at all times! The rig plate must always be under tension in your system to help prevent equipment shifting into an incorrect position.

Stay Up To Date!

Regularly go to our website and read the latest user instructions.

Copyright 2010 Rock Exotica Equipment LC

Inspect Before & After Use

Check for cracks, deformation, corrosion, wear, etc.

Inspection During Use

Regularly inspect and monitor your system, confirming proper connections, equipment position, fully locked connectors, etc.

Thorough and specific training is absolutely essential before use.

Being at height is dangerous and it is up to you to reduce the risks as much as possible - but the risks can never be eliminated. There are many ways to misuse this equipment, too many to list or imagine. You must personally understand and assume all risks and responsibilities of using this equipment. If you cannot or do not want to do this, do not use this equipment.

Environmental Factors

Moisture, ice, salt, sand, snow, chemicals and other factors can prevent proper operation or can greatly accelerate wear.

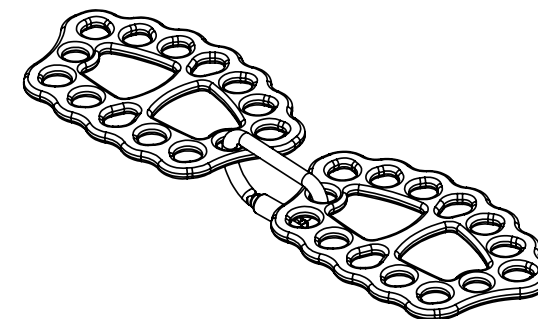

The middle holes at each end of the Se7en can be used to connect two together. They can also be used to help position the rigplate laterally. Note: This requires advanced skills and experience. These holes should not be used as general-purpose holes because they are not as strong as the other holes. Use for positioning, not for high force.

Compatibility

Verify compatibility with other components of your system. Incompatible connections can cause detachment, breakage, etc.

Lifetime

10 years maximum, but will often be much less depending on conditions and use; it could even be a single use in some cases.

Retire from Service & Destroy if it:

1. Is significantly loaded.
 2. Does not pass inspection or there is any doubt about its safety.
 3. Is misused, altered, damaged, exposed to harmful chemicals, etc.
 4. Usage history is not known.
- Consult the manufacturer if you have any doubts or concerns.

Maintenance & Storage

Clean if necessary with fresh water, then allow to dry completely. Store in a dry place away from extremes of heat and cold and avoid chemical exposure.

Principal Material

Aluminum alloy, anodized.

Repairs or Modifications to Equipment

Are only allowed by the manufacturer or those authorized in writing by the manufacturer.

Detailed Inspection

In addition to inspection before, during and after each use, a detailed inspection by a competent inspector must be done at least every 3 months or more frequently depending on amount and type of use. Make a copy of these instructions and use one as the permanent inspection record and keep the other with the equipment. It is best to issue new gear to each user so they know its entire history.

PURCHASE RECORD		DATE	CONDITION	INSPECTOR
Model				
Complete Batch #				
Year of Manufacture				
Purchase Date				
Date of 1st Use				
User				